



### **5X Racing 99-05 Miata Radio Delete Plate Installation Instructions**

Thank you for purchasing our unique, aluminum race inspired radio delete plate for your 1999-2005 Mazda Miata! These instructions will guide you on how to properly install the plate on your Miata.

**DISCLAIMER!** The NB Miata radio bay is not an ideal mounting surface for a delete plate. There are a few tight tolerances involved with installing the plate, and some areas might need to be trimmed or filed down to ensure proper fitment. It is possible that you will need to make adjustments at your discretion and trim or file certain sections. We will point out problem areas during this guide, but every car is different and there might be a need for further “creativity” to get it to fit just right.

#### *Tools Needed:*

- *Phillips Head screwdriver*
- *Flat head screwdriver*
- *Razor knife*
- *Flat file*
- *Two pennies*

1. Remove center console following factory service manual procedures (*basically, remove the shift knob, two screws in the storage bay, one screw under the ashtray, and two screws on each side of the transmission tunnel*)
2. Once the console is removed, remove the two screws holding the radio bezel beneath the airbag switch



3. Remove radio bezel by grabbing it from the bottom, then pulling it evenly towards the shifter. Take care not to bend it or pull it from only one spot, but rather distribute the pull-load evenly across the stronger points of the bezel



4. Once the bezel is removed, there might be a horizontal plastic bar spanning from side to side that must be removed. Some models might not have it (our 99 did, our 2002 did not). If it is present, remove it by twisting it off or snipping it with a pair of cutters

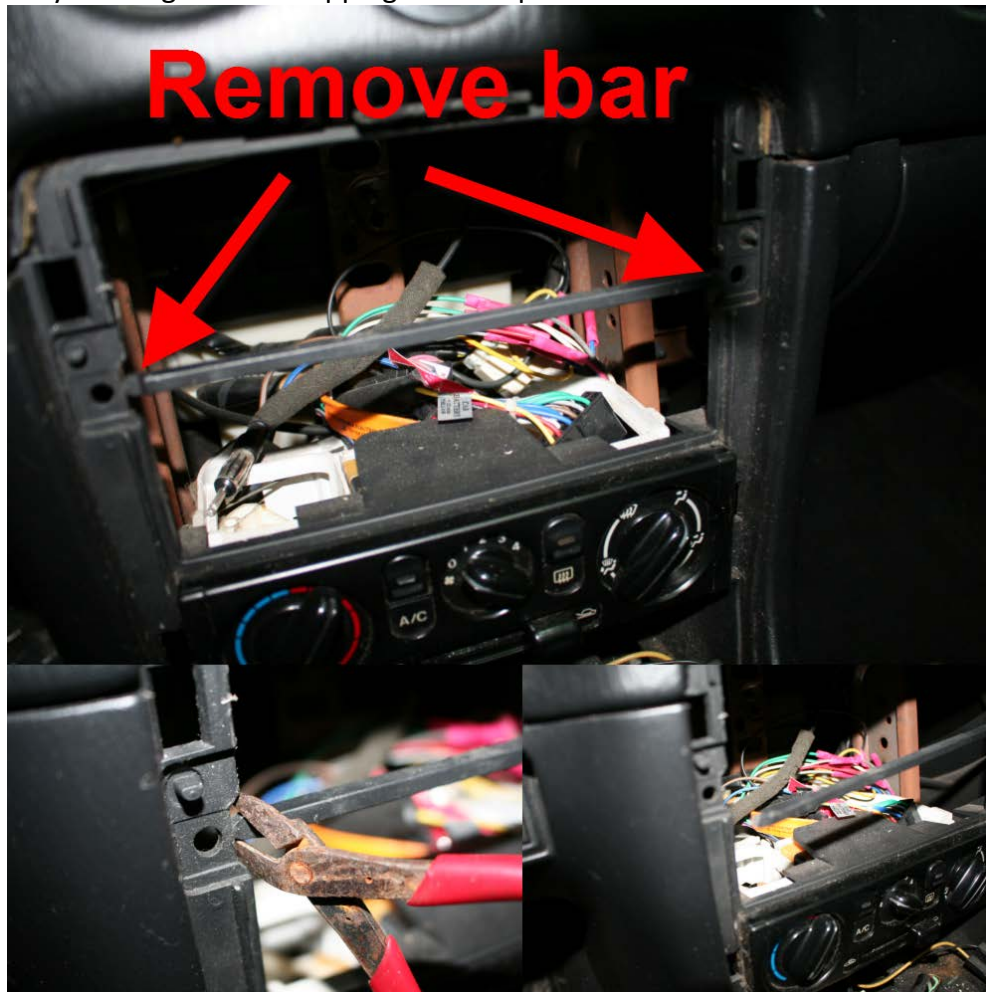



5. There is an area of the dash pad that extends down on the inner top-most portion of the bezel recess that must be trimmed before the plate is installed. Use a razor to trim back the area between the two rectangle slots even with the edge above the slots. This will allow the plate to seat properly







6. Find the threaded clip inserts and snap them into place over the holes on each side of the bezel recess. The flat part of the clip needs to be facing you, the angled part of the clip should be facing the engine

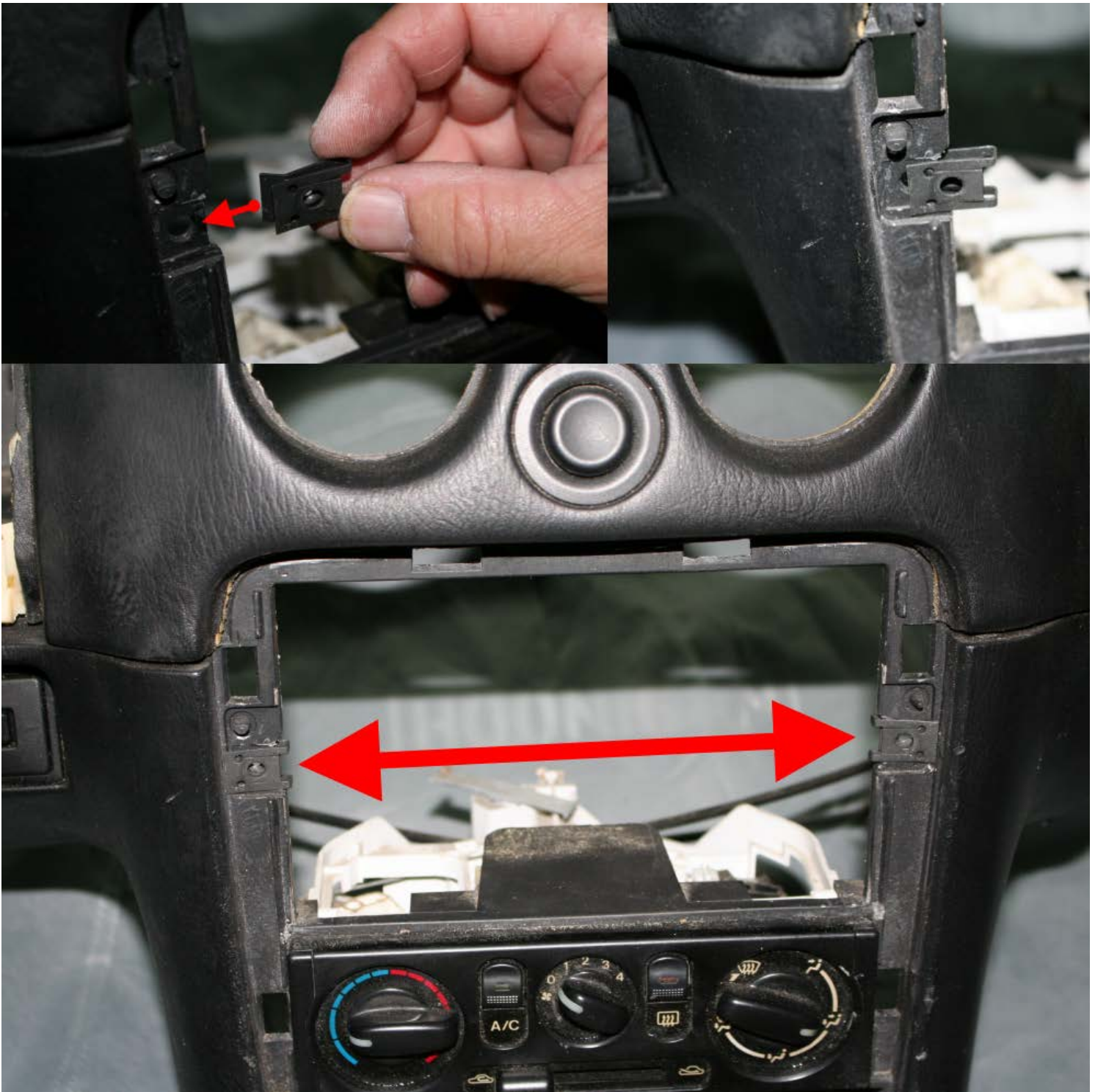

7. Find the two phillips head screws and plastic spacers. Push the screws through the two holes on the plate, and then slide the spacer over the back side of the screw. The spacers ensure proper depth of the plate. Snug the plate by screwing it into the threaded clips in the bezel recess, but do not tighten. If the top of the plate does not seat properly, you might need to trim more of the dash pad outline in step 5

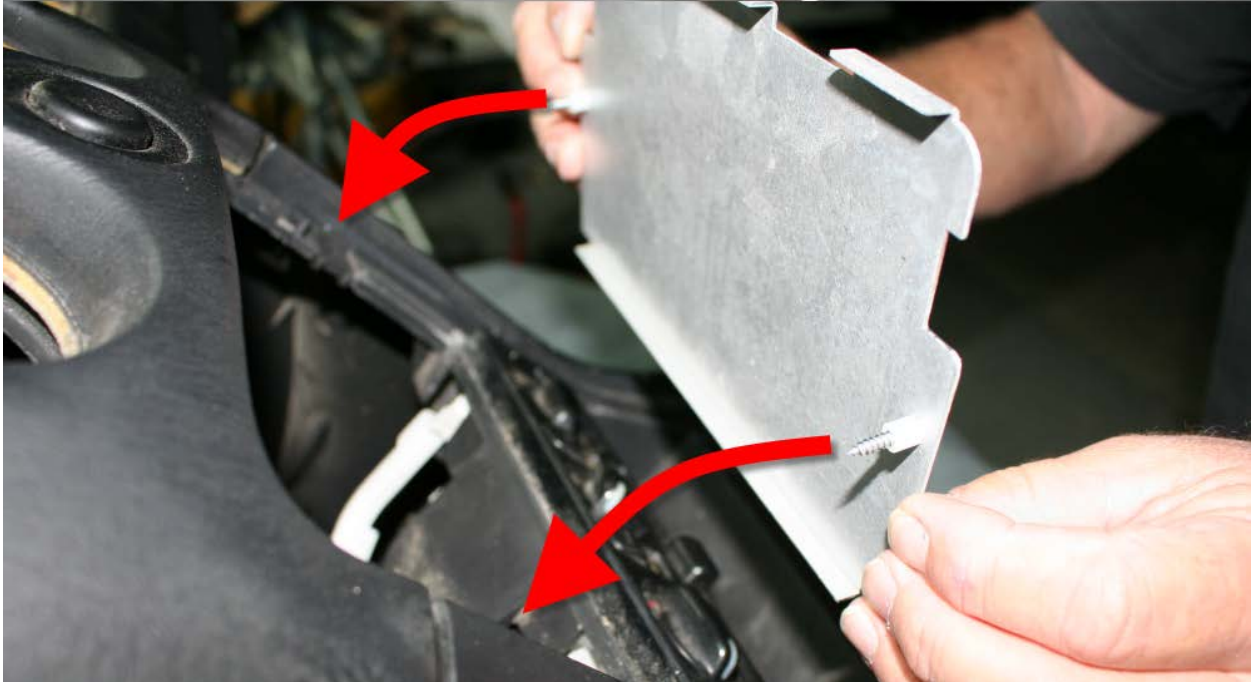
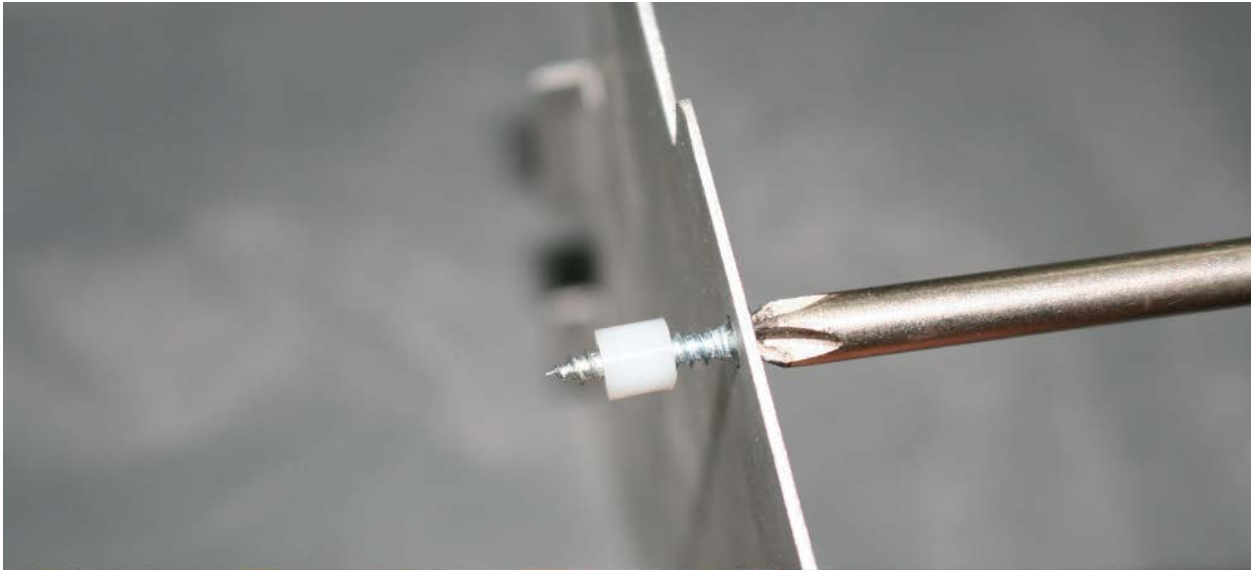



8. Take a flat head screwdriver and gently pry up on the gap on the bottom of the plate. This gap is important to set and can be checked correctly if the two pennies fit snugly. You'll want to make sure both sides are evenly gapped

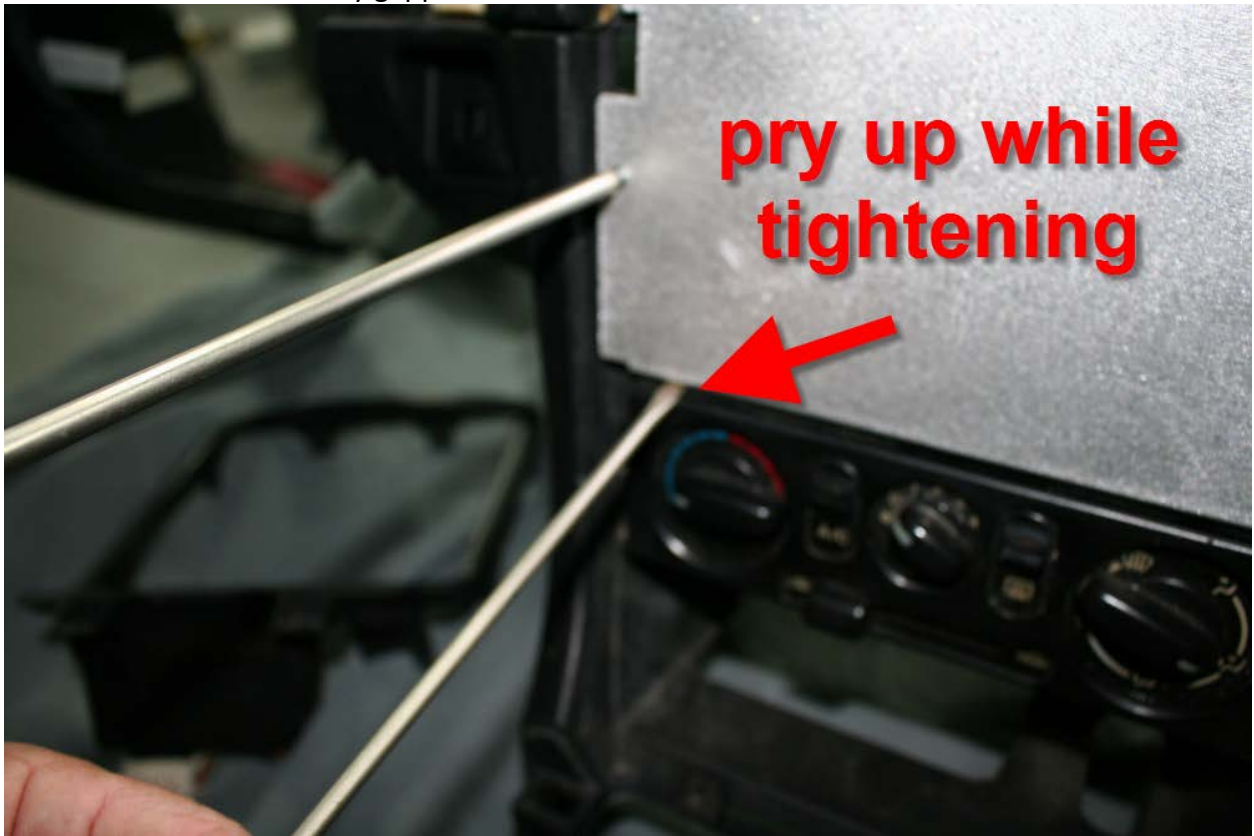

9. The plate should be installed firmly at this point.





**a. POTENTIAL PROBLEM AREA**

- i. The side tabs on the radio bezel will be a tight fit going past the notches in the radio plate where they snap into the dash, so we recommend taking a file and shaving some material off the bottom and top of the bezel side tabs to ensure the tolerances are not too tight and cause the bezel to warp when snapped in. Use your judgement on how much material to remove. Try installing the bezel to see how it fits, then remove some material, and re-fit it. Repeat this process until the bezel sits as close to the plate as possible (flush)



10. Snap the bezel back onto the dash with the top tabs first, then side, then bottom





11. With the bezel installed, it should press fairly flush to the plate. If it is not flush, try trimming the tabs again to get a better fit. The bezel should snap in with minimal effort. If it feels like it's just not snapping in like it should, further trimming of the bezel tabs might be needed



The edge of the notches in the plate might be slightly visible on some cars at a low angle due to the tolerance allowance built into the plates. You should not see them when sitting in the car with the way they are angle

12. This completes the installation of your 5X Racing 1999-2005 Mazda Miata Radio Delete Plate! Enjoy and let us know how you like the plate by leaving a review on our site!

